

PVC PROFILE FITTINGS

Price List: PLF-PF Vol.4

Effective Date: March 1, 2016

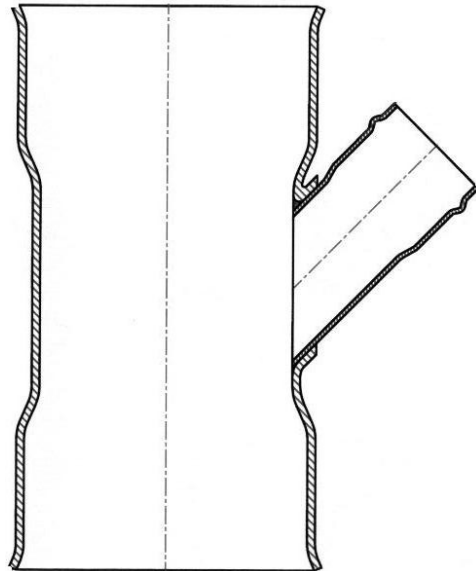

Western Canada

12487-82nd Avenue,
Surrey B.C. V3W 3E8
T: 604-531-8408 / 1- 877-531-8478
F: 604-531-8468 / 1- 877-531-8468
info@pro-linefittings.com

Eastern Canada

740 Huronia Road, Unit #17
Barrie, Ontario L4N 6C6
T: 705-733-7720 / 1-855-733-7720
F: 705-733-7710 / 1-855-733-7710
sales@pro-linefittings.com

Contents;

◆ PVC Profile Wyes	1-3
◆ PVC Profile Tees	4-6
◆ PVC Profile Bends	7
◆ PVC Profile Increases	8-9
◆ PVC Profile Couplings	10
◆ PVC Profile Sanded Stubs	10
◆ PVC Profile Adapters	10
◆ PVC Profile Caps & Spigot Plugs	11



CSA B 181.0-06, CSA B 182.1-06, CSA B 182.2-06, CSA B 182.4-06

ASTM D3034, ASTM D3212, ASTM F1336, ASTM F679, ASTM F794.

At Pro-Line we're committed to **CUSTOMER SERVICE EXCELLENCE**.
This means quick quotes, the highest quality fittings, delivered as promised each and every time.

PRO-LINE FITTINGS

PROFILE FITTINGS

Wyes HxHxG

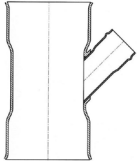

Inches	MM	Product Code	Crate Quantities	Unit Price
08x08x04	200x200x100	03UA080804HHG		183.76
08x08x06	200x200x150	03UA080806HHG		225.28
08x08x08	200x200x200	03UA080808HHG		382.60
10x10x04	250x250x100	03UA101004HHG		333.52
10x10x06	250x250x150	03UA101006HHG		385.28
10x10x08	250x250x200	03UA101008HHG		575.56
10x10x10	250x250x250	03UA101010HHG		618.88
12x12x04	300x300x100	03UA121204HHG		540.60
12x12x06	300x300x150	03UA121206HHG		596.44
12x12x08	300x300x200	03UA121208HHG		663.68
12x12x10	300x300x250	03UA121210HHG		955.32
12x12x12	300x300x300	03UA121212HHG		1017.36
15x15x04	375x375x100	03UA151504HHG		819.56
15x15x06	375x375x150	03UA151506HHG		849.36
15x15x08	375x375x200	03UA151508HHG		967.16
15x15x10	375x375x250	03UA151510HHG		1223.88
15x15x12	375x375x300	03UA151512HHG		1280.80
15x15x15	375x375x375	03UA151515HHG		1990.48
18x18x04	450x450x100	03UA181804HHG		1084.36
18x18x06	450x450x150	03UA181806HHG		1137.80
18x18x08	450x450x200	03UA181808HHG		1287.40
18x18x10	450x450x250	03UA181810HHG		1630.32
18x18x12	450x450x300	03UA181812HHG		1705.84
18x18x15	450x450x375	03UA181815HHG		2609.72
18x18x18	450x450x450	03UA181818HHG		3704.36
21x21x04	525x525x100	03UA212104HHG		1456.16
21x21x06	525x525x150	03UA212106HHG		1585.36
21x21x08	525x525x200	03UA212108HHG		1862.16
21x21x10	525x525x250	03UA212110HHG		2832.92
21x21x12	525x525x300	03UA212112HHG		3250.36
21x21x15	525x525x375	03UA212115HHG		3754.36

PRO-LINE FITTINGS

PROFILE FITTINGS

Wyes HxHxG

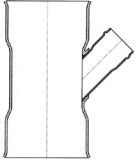

Inches	MM	Product Code	Crate Quantities	Unit Price
21x21x18	525x525x450	03UA212118HHG		4356.48
21x21x21	525x525x525	03UA212121HHG		4982.88
24x24x04	600x600x100	03UA242404HHG		2353.24
24x24x06	600x600x150	03UA242406HHG		2384.48
24x24x08	600x600x200	03UA242408HHG		2630.16
24x24x10	600x600x250	03UA242410HHG		2998.20
24x24x12	600x600x300	03UA242412HHG		3371.36
24x24x15	600x600x375	03UA242415HHG		4657.72
24x24x18	600x600x450	03UA242418HHG		5386.72
24x24x21	600x600x525	03UA242421HHG		6489.80
24x24x24	600x600x600	03UA242424HHG		7537.72

Wyes HxHxH

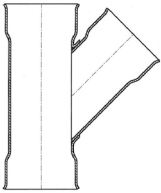

08x08x08	200x200x200	03UU080808HHH		400.80
10x10x08	250x250x200	03UU101008HHH		549.92
10x10x10	250x250x250	03UU101010HHH		679.64
12x12x08	300x300x200	03UU121208HHH		709.84
12x12x10	300x300x250	03UU121210HHH		888.32
12x12x12	300x300x300	03UU121212HHH		1261.36
15x15x08	375x375x200	03UU151508HHH		995.00
15x15x10	375x375x250	03UU151510HHH		1145.60
15x15x12	375x375x300	03UU151512HHH		1313.52
15x15x15	375x375x375	03UU151515HHH		1882.96
18x18x08	450x450x200	03UU181808HHH		1428.16
18x18x10	450x450x250	03UU181810HHH		1516.48
18x18x12	450x450x300	03UU181812HHH		1662.32
18x18x15	450x450x375	03UU181815HHH		2369.68
18x18x18	450x450x450	03UU181818HHH		3332.72
21x21x08	525x525x200	03UU212108HHH		2606.72
21x21x10	525x525x250	03UU212110HHH		2668.48
21x21x12	525x525x300	03UU212112HHH		3031.20

** PVC Profile Fittings available in 30" and 36".*

PRO-LINE FITTINGS

PROFILE FITTINGS

Wyes HxHxH

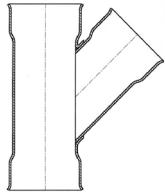

Inches	MM	Product Code	Crate Quantities	Unit Price
21x21x15	525x525x375	03UU212115HHH		3815.64
21x21x18	525x525x450	03UU212118HHH		4589.84
21x21x21	525x525x525	03UU212121HHH		5388.36
24x24x08	600x600x200	03UU242408HHH		2853.96
24x24x10	600x600x250	03UU242410HHH		2991.76
24x24x12	600x600x300	03UU242412HHH		3332.44
24x24x15	600x600x375	03UU242415HHH		4583.68
24x24x18	600x600x450	03UU242418HHH		5579.24
24x24x21	600x600x525	03UU242421HHH		6542.84
24x24x24	600x600x600	03UU242424HHH		7348.68

** PVC Profile Fittings available in 30" and 36".*

PRO-LINE FITTINGS

PROFILE FITTINGS

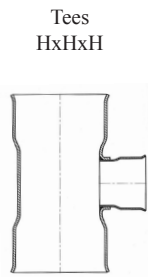

Inches	MM	Product Code	Crate Quantity	List Price
08x08x08	200x200x200	09UU080808HHH		298.88
10x10x08	250x250x200	09UU101008HHH		305.00
10x10x10	250x250x250	09UU101010HHH		451.00
12x12x08	300x300x200	09UU121208HHH		468.24
12x12x10	300x300x250	09UU121210HHH		572.08
12x12x12	300x300x300	09UU121212HHH		624.12
15x15x08	375x375x200	09UU151508HHH		624.12
15x15x10	375x375x250	09UU151510HHH		624.12
15x15x12	375x375x300	09UU151512HHH		649.92
15x15x15	375x375x375	09UU151515HHH		988.12
18x18x08	450x450x200	09UU181808HHH		675.32
18x18x10	450x450x250	09UU181810HHH		758.96
18x18x12	450x450x300	09UU181812HHH		791.00
18x18x15	450x450x375	09UU181815HHH		935.92
18x18x18	450x450x450	09UU181818HHH		1870.36
21x21x08	525x525x200	09UU212108HHH		863.32
21x21x10	525x525x250	09UU212110HHH		978.60
21x21x12	525x525x300	09UU212112HHH		1004.76
21x21x15	525x525x375	09UU212115HHH		1096.32
21x21x18	525x525x450	09UU212118HHH		2379.64
21x21x21	525x525x525	09UU212121HHH		2979.80
24x24x08	600x600x200	09UU212118HHH		1003.32
24x24x10	600x600x250	09UU212118HHH		1325.72
24x24x12	600x600x300	09UU212118HHH		1485.28
24x24x15	600x600x375	09UU212118HHH		2548.36
24x24x18	600x600x450	09UU212118HHH		3669.80
24x24x21	600x600x525	09UU212118HHH		3678.84
24x24x24	600x600x600	09UU212118HHH		3887.80

** PVC Profile Fittings available in 30" and 36".*

PROFILE FITTINGS

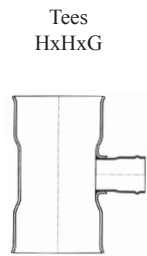

Inches	MM	Product Code	Crate Quantities	Unit Price
08x08x04	200x200x100	09UA080804HHG		147.84
08x08x06	200x200x150	09UA080806HHG		153.44
08x08x08	200x200x200	09UA080808HHG		212.76
10x10x04	250x250x100	09UA101004HHG		268.80
10x10x06	250x250x150	09UA101006HHG		306.88
10x10x08	250x250x200	09UA101008HHG		325.36
10x10x10	250x250x250	09UA101010HHG		568.32
12x12x04	300x300x100	09UA121204HHG		421.12
12x12x06	300x300x150	09UA121206HHG		459.20
12x12x08	300x300x200	09UA121208HHG		497.48
12x12x10	300x300x250	09UA121210HHG		535.68
12x12x12	300x300x300	09UA121212HHG		573.92
15x15x04	375x375x100	09UA151504HHG		461.96
15x15x06	375x375x150	09UA151506HHG		461.96
15x15x08	375x375x200	09UA151508HHG		498.36
15x15x10	375x375x250	09UA151510HHG		528.04
15x15x12	375x375x300	09UA151512HHG		543.44
15x15x15	375x375x375	09UA151515HHG		1183.96
18x18x04	450x450x100	09UA181804HHG		530.88
18x18x06	450x450x150	09UA181806HHG		535.76
18x18x08	450x450x200	09UA181808HHG		664.32
18x18x10	450x450x250	09UA181810HHG		665.28
18x18x12	450x450x300	09UA181812HHG		716.96
18x18x15	450x450x375	09UA181815HHG		916.80
18x18x18	450x450x450	09UA181818HHG		1979.80
21x21x04	525x525x100	09UA212104HHG		797.16
21x21x06	525x525x150	09UA212106HHG		857.96
21x21x08	525x525x200	09UA212108HHG		869.52
21x21x10	525x525x250	09UA212110HHG		985.16
21x21x12	525x525x300	09UA212112HHG		1013.44
21x21x15	525x525x375	09UA212115HHG		1118.64
21x21x18	525x525x450	09UA212118HHG		2336.60
21x21x21	525x525x525	09UA212121HHG		2956.32

** PVC Profile Fittings available in 30" and 36".*

PRO-LINE FITTINGS

PROFILE FITTINGS

Tees
HxHxG

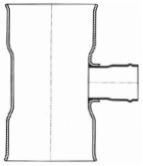

Inches	MM	Product Code	Crate Quantities	Unit Price
24x24x04	600x600x100	09UA242404HHG		984.80
24x24x06	600x600x150	09UA242406HHG		989.56
24x24x08	600x600x200	09UA242408HHG		1073.24
24x24x10	600x600x250	09UA242410HHG		1158.76
24x24x12	600x600x300	09UA242412HHG		1289.92
24x24x15	600x600x375	09UA242415HHG		2531.72
24x24x18	600x600x450	09UA242418HHG		3376.68
24x24x21	600x600x525	09UA242421HHG		3388.68
24x24x24	600x600x600	09UA242424HHG		3901.68

** PVC Profile Fittings available in 30" and 36".*

PRO-LINE FITTINGS

PROFILE FITTINGS

22.5° Bend HxH

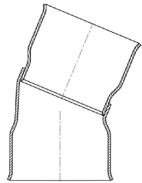

Inches	MM	Product Code	Crate Quantities	Unit Price
8"	200	26U2208HH		209.56
10"	250	26U2210HH		439.56
12"	300	26U2212HH		676.72
15"	375	26U2215HH		832.20
18"	450	26U2218HH		1831.04
21"	525	26U2221HH		2403.88
24"	600	26U2224HH		3051.44

45° Bend HxH

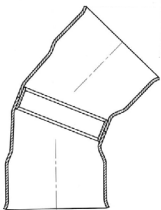

8"	200	26U4508HH		205.72
10"	250	26U4510HH		439.56
12"	300	26U4512HH		676.72
15"	375	26U4515HH		774.76
18"	450	26U4518HH		1643.20
21"	525	26U4521HH		2030.44
24"	600	26U4524HH		2802.76

90° Bend HxH

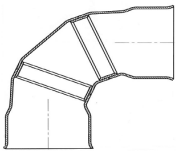

8"	200	26U9008HH		235.92
10"	250	26U9010HH		553.80
12"	300	26U9012HH		998.96
15"	375	26U9015HH		1095.80
18"	450	26U9018HH		2042.96
21"	525	26U9021HH		2392.00
24"	600	26U9024HH		3159.08

** PVC Profile Fittings available in 30" and 36".*

PROFILE FITTINGS

Increaser HxG

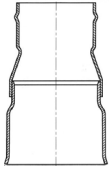

Inches	MM	Product Code	Crate Quantities	Unit Price
4x8	100x200	43AUIIN0408GH		294.44
6x8	150x200	43AUIIN0608GH		217.40
4x10	100x250	43AUIIN0410GH		329.28
6x10	150x250	43AUIIN0610GH		355.16
8x10	200x250	43AUIIN0810GH		285.96
4x12	100x300	43AUIIN0412GH		448.04
6x12	150x300	43AUIIN0612GH		473.84
8x12	200x300	43AUIIN0812GH		502.84
10x12	250x300	43AUIIN1012GH		467.28
4x15	100x375	43AUIIN0415GH		673.28
6x15	150x375	43AUIIN0615GH		719.28
8x15	200x375	43AUIIN0815GH		781.48
10x15	250x375	43AUIIN1015GH		835.68
12x15	300x375	43AUIIN1215GH		815.32
4x18	100x450	43AUIIN0418GH		1345.80
6x18	150x450	43AUIIN0618GH		1333.84
8x18	200x450	43AUIIN0818GH		1370.72
10x18	250x450	43AUIIN1018GH		1382.60
12x18	300x450	43AUIIN1218GH		1388.84
15x18	375x450	43AUIIN1518GH		1720.68
4x21	100x525	43AUIIN0421GH		1751.28
6x21	150x525	43AUIIN0621GH		1640.76
8x21	200x525	43AUIIN0821GH		1690.16
10x21	250x525	43AUIIN1021GH		1867.88
12x21	300x525	43AUIIN1221GH		2009.40
15x21	375x525	43AUIIN1521GH		2091.76
18x21	450x525	43AUIIN1821GH		2076.92
4x24	100x600	43AUIIN0424GH		2027.20
6x24	150x600	43AUIIN0624GH		1597.72
8x24	200x600	43AUIIN0824GH		1942.16
10x24	250x600	43AUIIN1024GH		2162.96
12x24	300x600	43AUIIN1224GH		2238.72
15x24	375x600	43AUIIN1524GH		2462.84
18x24	450x600	43AUIIN1824GH		3021.12
21x24	525x600	43AUIIN2124GH		3537.60

** PVC Profile Fittings available in 30" and 36".*

PRO-LINE FITTINGS

PROFILE FITTINGS

Increaser HxH

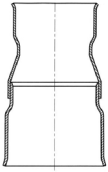

Inches	MM	Product Code	Crate Quantities	Unit Price
8x10	200x250	52UUIIN0810HH		340.88
8x12	200x300	52UUIIN0812HH		504.16
8x15	200x375	52UUIIN0815HH		856.76
8x18	200x450	52UUIIN0818HH		1267.44
8x21	200x525	52UUIIN0821HH		1690.16
8x24	200x600	52UUIIN0824HH		1942.08
10x12	250x300	52UUIIN1012HH		425.92
10x15	250x375	52UUIIN1015HH		817.60
10x18	250x450	52UUIIN1018HH		1382.60
10x21	250x525	52UUIIN1021HH		1794.36
10x24	250x600	52UUIIN1024HH		2162.96
12x15	300x375	52UUIIN1215HH		771.28
12x18	300x450	52UUIIN1218HH		1388.84
12x21	300x525	52UUIIN1221HH		1966.52
12x24	250x600	52UUIIN1224HH		2257.28
15x18	375x450	52UUIIN1518HH		1726.84
15x21	375x525	52UUIIN1521HH		2027.64
15x24	375x600	52UUIIN1524HH		2418.84
18x21	450x525	52UUIIN1821HH		2316.48
18x24	450x600	52UUIIN1824HH		2765.28
21x24	525x600	52UUIIN2124HH		3310.88

** PVC Profile Fittings available in 30" and 36".*

PROFILE FITTINGS

Adapter HxG

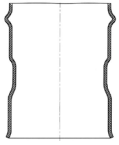

Inches	MM	Product Code	Crate Quantities	Unit Price
8"	200	37UA0808HG		124.76
10"	250	37UA1010HG		204.44
12"	300	37UA1212HG		270.48
15"	375	37UA1515HG		554.64
18"	450	37UA1818HG		825.04
21"	525	37UA2121HG		1795.60
24"	600	37UA2424HG		2072.12

Adapter HxSP

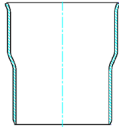

8"	200	36UA0808HS		61.76
10"	250	36UA1010HS		94.84
12"	300	36UA1212HS		161.24
15"	375	36UA1515HS		275.00
18"	450	36UA1818HS		501.72
21"	525	36UA2121HS		670.08
24"	600	36UA2424HS		926.28

Sanded Manhole
Adapters HxS



8"	200	65USD0815HS		72.72
10"	250	65USD1015HS		102.60
12"	300	65USD1215HS		181.92
15"	375	65USD1515HS		279.48
18"	450	65USD1815HS		560.52
21"	525	65USD2115HS		701.52
24"	600	65USD2415HS		928.92

** PVC Profile Fittings available in 30" and 36".*

PRO-LINE FITTINGS

PROFILE FITTINGS

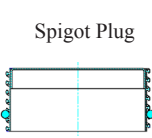

Inches	MM	Product Code	Crate Quantities	Unit Price
8"	200	44UPLUG08		253.16
10"	250	44UPLUG10		376.72
12"	300	44UPLUG12		483.08
15"	375	44UPLUG15		632.92
18"	450	44UPLUG18		1254.40
21"	525	44UPLUG21		1560.48
24"	600	44UPLUG24		2091.28

Profile Caps x H

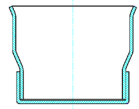

8"	200	41UCAP08H		232.08
10"	250	41UCAP10H		276.76
12"	300	41UCAP12H		397.56
15"	375	41UCAP15H		640.12
18"	450	41UCAP18H		1477.84
21"	525	41UCAP21H		2025.68
24"	600	41UCAP24H		2248.56

Coupling
With Stop HxH

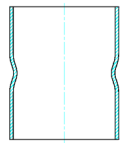

8"	200	35UCOUP08HH		154.60
10"	250	35UCOUP10HH		268.84
12"	300	35UCOUP12HH		386.96
15"	375	35UCOUP15HH		495.00
18"	450	35UCOUP18HH		1043.08
21"	525	35UCOUP21HH		1300.32
24"	600	35UCOUP24HH		1663.00

Repair Coupling
No Stop HxH

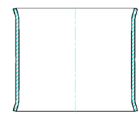

8"	200	32UCOUP08HH		154.60
10"	250	32UCOUP10HH		238.76
12"	300	32UCOUP12HH		338.64
15"	375	32UCOUP15HH		455.80
18"	450	32UCOUP18HH		957.00
21"	525	32UCOUP21HH		1300.32
24"	600	32UCOUP24HH		1640.76

PRO-LINE FITTINGS

Terms and Conditions of Sale

1. General

All sales are subject to Pro-Line's Fittings Inc. ("Vendor") general terms and conditions as posted on the Vendor's website at the time of sale. The Purchaser's order is accepted subject to the Vendor's terms and condition and any other terms and conditions agreed to in writing by the Vendor and Purchaser. It is agreed that any terms and conditions contained in the Purchaser's order or otherwise stipulated will be deemed for the Purchaser's internal use only and will not be binding on the Vendor.

2. Orders:

Purchase orders received are conditional upon satisfactory credit approval by the Vendor. Once confirmed by the Vendor orders for custom-made products manufactured by the Purchaser's specifications and orders of large quantities for non-inventoried products cannot be cancelled, modified or returned without the Vendor's written consent and upon terms which provide for indemnification of the Vendor for costs and expenses incurred.

3. Shipments

Delivery schedules stipulated in either the Vendor's "Sales Quote" or the "Sales Order Confirmation" are approximate only and shipments will be made within reasonable proximity thereto. All shipments are F.O.B Vendor's location unless otherwise agreed to in writing between the Vendor and Purchaser. The Vendor may agree to different shipping terms as specified in the Sales Quote or in the Sales Order Confirmation. Freight prepaid orders, when applicable will be delivered by the carrier of the Vendor's selection, unless the use of another carrier is agreed to in writing with the Purchaser. Prepaid orders will be delivered based on the most economical route as determined by the Vendor. If the Purchaser requires another means of delivery that offered by the Vendor, the Purchaser agrees to incur the additional cost. Each Sales Order Confirmation maybe shipped in whole or in part at the Vendor's discretion. The Vendor shall bear no liability for Products lost or damaged during transit. Under no circumstances will the Vendor be responsible for any damage whatsoever caused by delays in shipment. The Purchaser must verify quantities and report discrepancies within 3 business days of receipt. The Vendor reserves the right to optimize packaging at its discretion. Some products may only be available in bulk package multiples or case quantities.

4. Prices

All prices published or quoted are subject to change without notice until orders are accepted by the Vendor and issuance of a Sales Confirmation, whereupon prices will remain firm for those shipments within thirty (30) days following the day of the Vendor's Sales Order Confirmation. For specific contracts or projects, the Vendor may agree to in writing to protect the prices for an extended period of time. To remove a charge for applicable taxes, the Purchaser must provide the Vendor with tax exemption certificates or any documents as required by a specific tax jurisdiction.

5. Payment Terms

Payment is based on the delivery date of the products and is due by the fifteenth (15th) of the following month. If applicable, cash discounts, expressed and a percentage, are calculated on the net invoiced price, before taxes, freight, or other charges and can only be deducted from the payment if the Vendor received payment from the Purchaser on or prior to the due date, otherwise no cash discount is applicable. Overdue accounts shall bear interest at rate of 18% per annum. The granting of credit by the Vendor is based on an evaluation of the Purchaser's financial condition. If the financial condition does not justify continuance on credit, the Vendor may require full or partial advance payment.

6. Return of Products:

The Vendor may accept the return of Products, subject to the following terms and conditions: 1) Prior to the return of any Products, the Purchaser must obtain a Return Goods Authorization (RGA) number from the Vendor, 2) All Products must be returned freight prepaid, unless otherwise authorized by the Vendor, 3) Products must be received in good salable condition. A minimum return or re-stocking charge of 25% of the purchase price will be applied against the credit issued pursuant to the returned Products, except in the case of the Vendor's shipping error.

Terms and Conditions of Sale

7. Warranty and Limitations of Liability

All the Vendor's Products are guaranteed against defects resulting from faulty workmanship or materials, subject to limitations, exceptions, disclaimers and conditions stipulated hereunder or specified with respect to particular Products and posted or amended on the Vendor's website of literature. The Vendor will replace free of charge, including shipping charges for the replacement of any Products which are found to be defective in workmanship or material provided that the following conditions are met.

- a. The Vendor is promptly notified in writing of such a defect immediately upon discovery and the defective Products is promptly returned to the Vendor. The Claimant must provide documentation of evidence of failure, as well as the failed product that has alleged to have failed and agree to in section of the defective Product by the Vendor.
- b. The Product has not been altered or modified after leaving the Vendor's premises, has not been used in more than one installation, show no evidence of tampering or disassembly, not subject to abnormal operating conditions, abuse or misuse.
- c. The Products have been used in applications or under conditions that are in not accordance with the technical information available from the Vendor.
- d. The Vendor disclaims any liability or responsibility for labour, materials and or other expenses to replace the defective Product or to repair and damage resulting from the use there of; for Purchaser's calculations, product design or engineering specifications; for the accuracy of any plans, drawing or specifications furnished to the purchaser as part of the sale of any of its products.



Contacts:

Western Canada

12487-82nd Avenue,
Surrey B.C. V3W 3E8

T: 604-531-8408 / 1- 877-531-8478
F: 604-531-8468 / 1- 877-531-8468

info@pro-linefittings.com

Eastern Canada

740 Huronia Road, Unit #17
Barrie, Ontario L4N 6C6

T: 705-733-7720 / 1-855-733-7720
F: 705-733-7710 / 1-855-733-7710

sales@pro-linefittings.com